



PLAN
of *Portion N^o 109*
Parish of Ginninderra
County of Murray

Applied for under the 23rd clause of the Crown Lands Alienation Act of '61
by Joseph Bolton

Sale at Queanbeyan 28th Feb. 1877.
Country Lot B Portion 109
Vide Aln. 77. 4172 above lot not bid for

ACPO316, 11th June. Jane Emma Grant Conf^d 15th Oct 03.

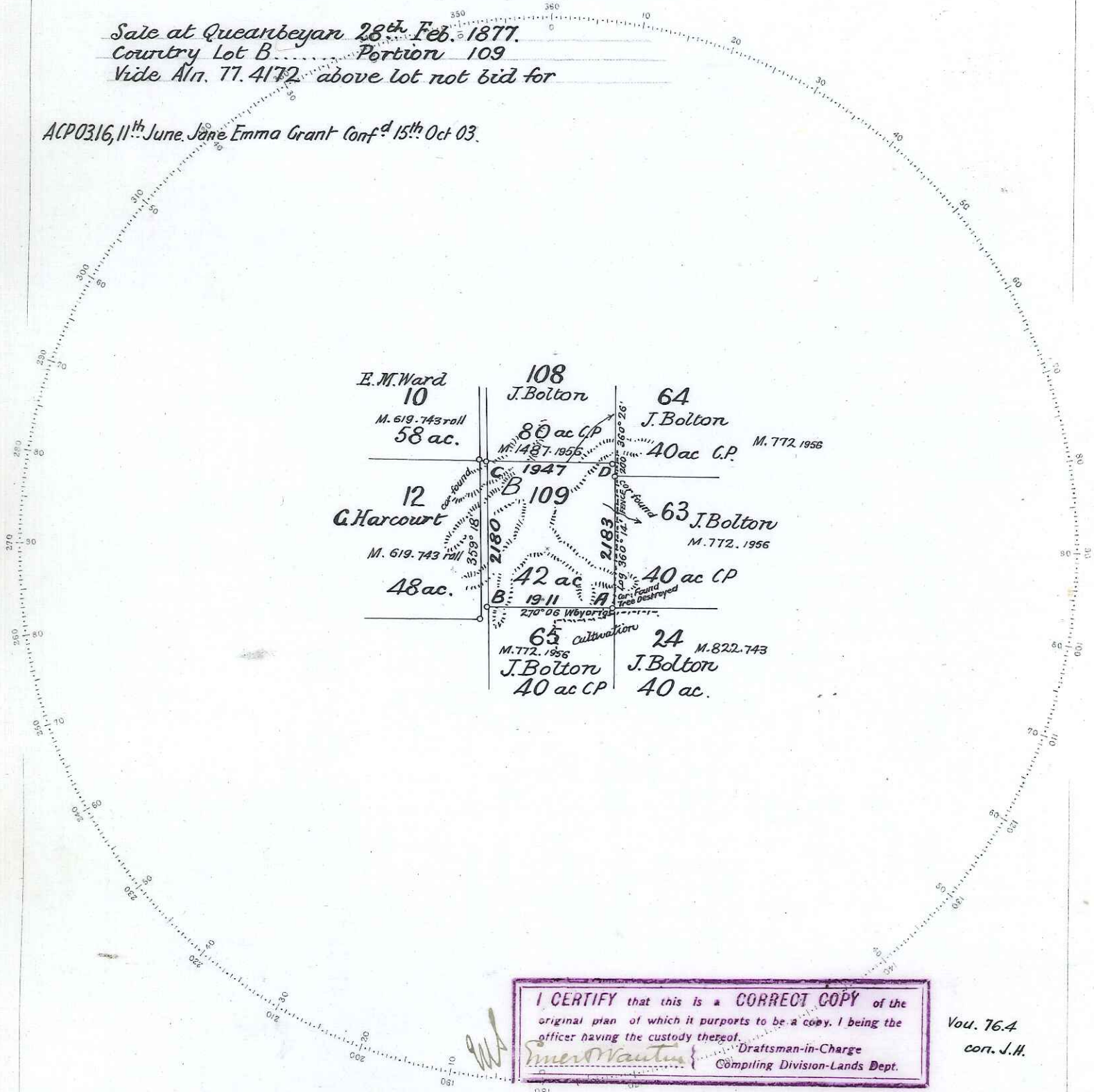

I CERTIFY that this is a CORRECT COPY of the original plan of which it purports to be a copy, I being the officer having the custody thereof.

Amos Wauters Draftsman-in-Charge
Compiling Division-Lands Dept.

Vol. 76.4
con. J.H.

Reference to Corners

Corner	Bearing	From	Links	N ^o on Tree
A		stake		
B	35°	gum	41	65-109
C	344°	str bark	57	108-109
D	94°	do	36	108-109

Reference to Traverse

Line	Bearing	Distance
109		

Scale 20 Chains to an Inch.

Marked in accordance with regulations
Instrument used in Survey, Theodolite
Date of Survey 26th July 1876
Value of Improvements £ nil

*Rugged barren stony land gum
apple sb bark. yel. box*

Plan accepted
A.J. 22. Nov. 76.

Cat. M. **1450** 1956.

Transmitted to the Surveyor General with my letter of the 28th August N^o 76. 148.
Geo. E. Faithfull Licensed Surveyor