

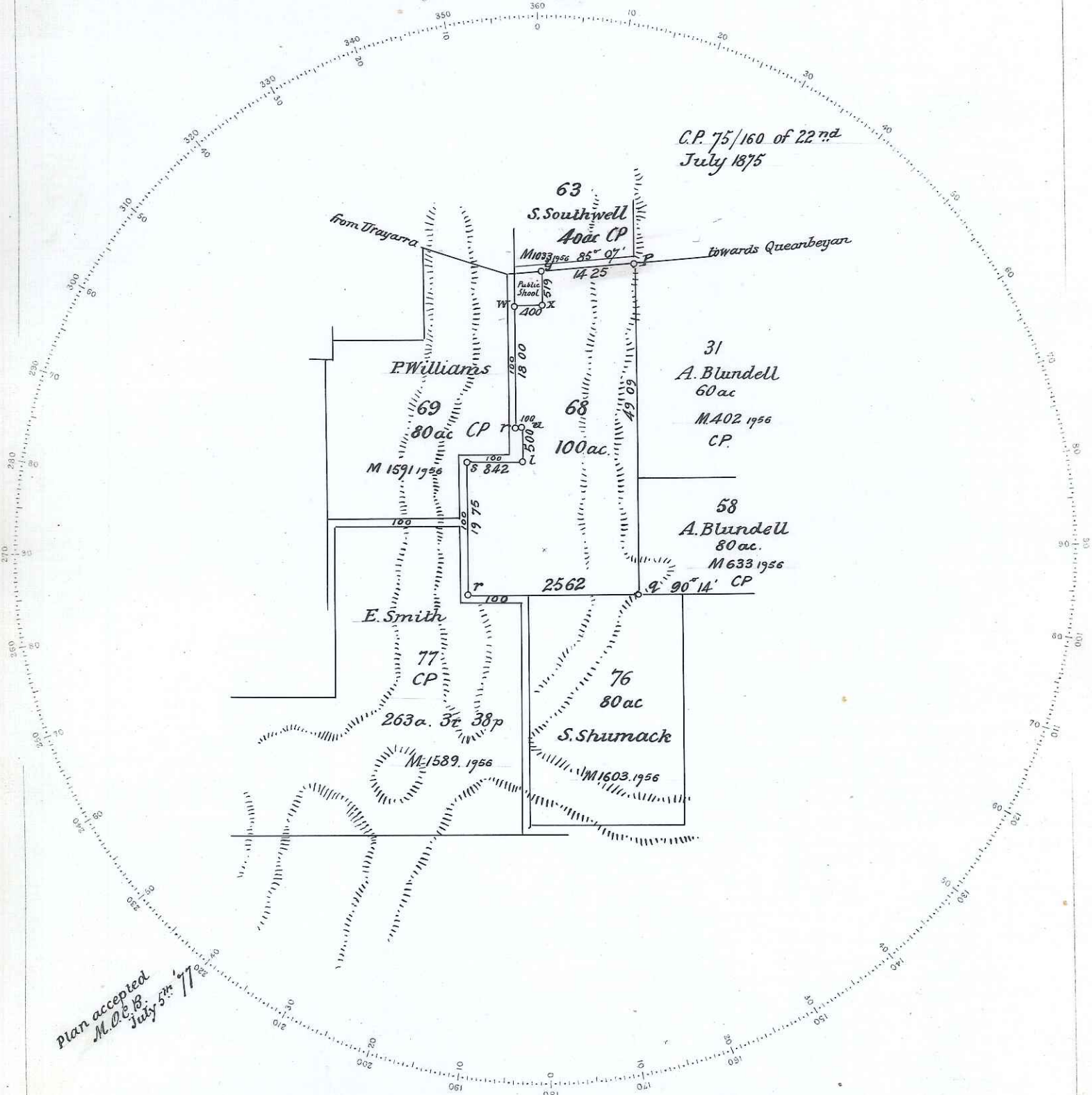

PLAN  
of Portion 68  
Parish of Weetangera  
County of Murray

Applied for under the 21. clause of the Crown Lands Alienation Act of/61  
by A. Blundell



C.P. 75/160 of 22<sup>nd</sup>  
July 1875

Plan accepted  
M.O.C.B.  
July 5<sup>th</sup> 77

Reference to Corners

Corner	Bearing	From	Links	N <sup>o</sup> on Triv
p	No tree near	(Removed)		
q	309°	Gum	13	58.68
r	72°	Gum	37	68
s	295°	Gum	38	68
t	313°	Gum	05	68
u	324°	Gum	16	68
v	36°	Gum	17	68
w	No tree near			
x	224°	Dead	20	71.68
y	No tree near			

Reference to Traverse

Line	Bearing	Distance
68		

Scale 20 Chains to an Inch.

Marked in accordance with regulations  
Instrument used in Survey, Circumferentor  
Date of Survey 4 Sept. 1876  
Value of Improvements £.nil

I CERTIFY that this is a CORRECT COPY of the original plan of which it purports to be a copy. I being the officer having the custody thereof.  
J. B. Thompson  
Draftsman-in-Charge  
Compiling Division-Lands Dept.

Acc<sup>t</sup> p<sup>ss</sup>a  
Vol. 77/1 1 con.

M.  
Cat. N<sup>o</sup> 1590 1956

Transmitted to the Surveyor General with my letter of the 16<sup>th</sup> May N<sup>o</sup> 77/10  
J.B. Thompson. Licensed Surveyor

Ed. J. ...