



PLAN  
of Portion N<sup>o</sup> 71  
Parish of Pialligo  
County of Murray

Applied for under the ~~clause of the Crown Lands Alienation Act of 1861~~

Applied for by the Council of Education as a Site for a Public School  
Approved 8<sup>th</sup> May 1878. Vide MS 78.636

Dedicated 28<sup>th</sup> June 1878

Deed to be prepared in favor of the Council of Education Vide MS 78.636

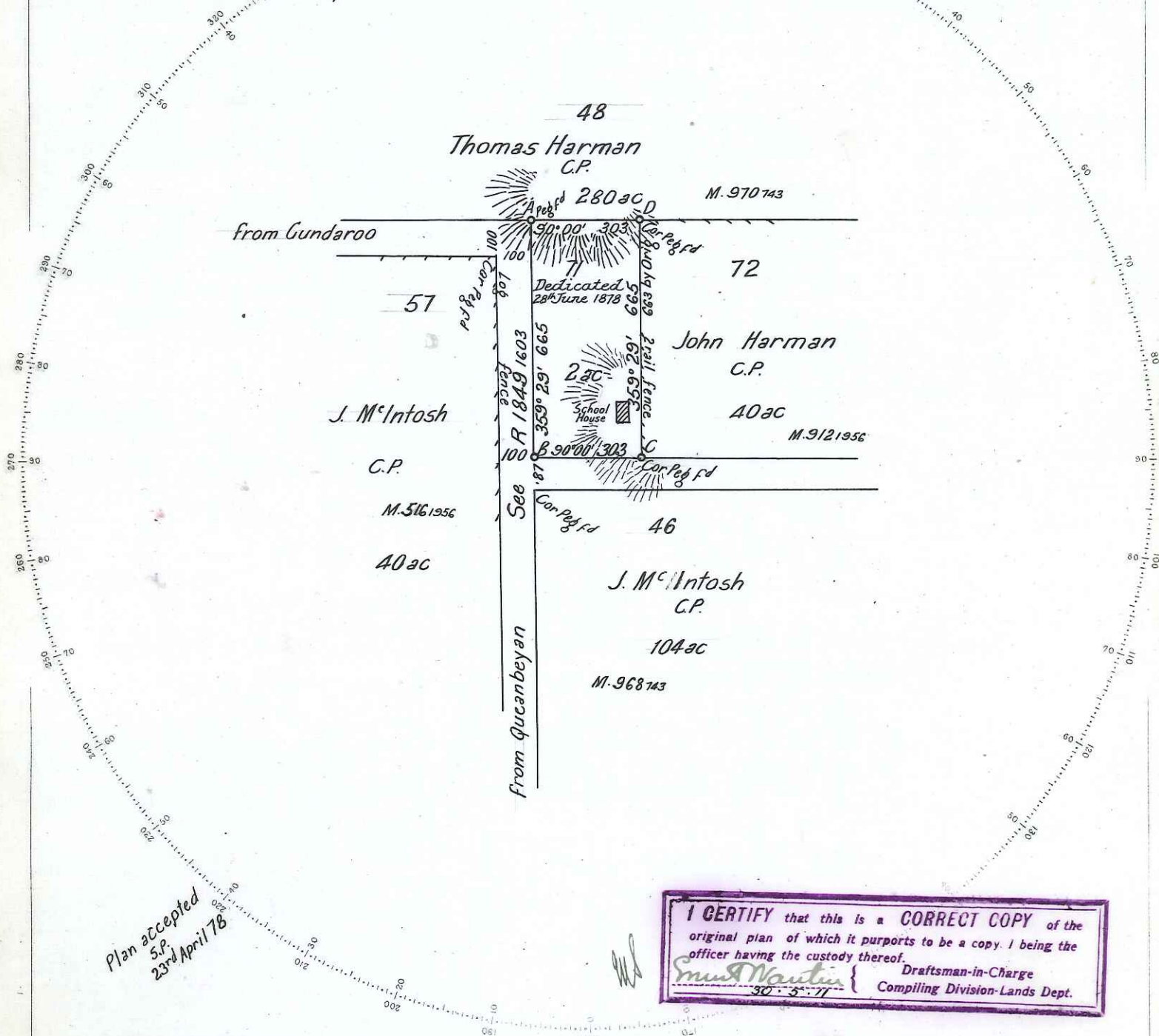

Plan accepted  
S.P.  
23<sup>rd</sup> April 78

I CERTIFY that this is a CORRECT COPY of the original plan of which it purports to be a copy, I being the officer having the custody thereof.  
*Ernest Martin*  
Draftsman-in-Charge  
Compiling Division-Lands Dept.

Reference to Corners

Corner	Bearing	From	Links	N <sup>o</sup> on Tree
A	337° 00'	Gum	58 1/2	71
B		Stake only (No tree near)		
C		Post 71.72 (No tree near)		
D	312° 00'	Gum	18	71.72

Reference to Traverse

Line	Bearing	Distance
71		

Scale 4 Chains to an Inch.

Marked in accordance with regulations  
Instrument used in Survey, Theodolite 5 inch  
Date of Survey 9<sup>th</sup> October 1877  
Value of Improvements School House, about £25  
Situating in the Police District of Queanbeyan  
Steel tape used in survey

You 77.21  
15 Sep  
23.4.78

Transmitted to the Surveyor General with my letter of the 31<sup>st</sup> December N<sup>o</sup> 77.120  
Charles W. Potter Licensed Surveyor

Cat. N<sup>o</sup> P. 422.1978

Printed at the Department of Lands, Sydney, N.S.W. 1911

C.W

NP of L.A. 11.206 D.

Ex. d  
20